



Sindhorn
Kempinski Hotel

BANGKOK

CITY WELLNESS SANCTUARY

Kempinski

HOTELIERS SINCE 1897

A Wellness Oasis, Designed with Space to Breathe

Sindhorn Kempinski Hotel Bangkok brings an exciting new green perspective to Asia's most vibrant city. Nestled close to Lumpini Park, Bangkok's 'green corridor' – home to embassies and Thailand's most prestigious residences, just four minutes from Chit Lom BTS station – the hotel features the largest guestrooms in the city. Much more than a hotel, this is a city wellness sanctuary located within Sindhorn Village; a fully integrated lifestyle destination, committed to helping guests experience the guilt-free good life with well-being in mind.



Facilities & Services

ROOMS & SUITES

- ♦ Total of 274 oversized rooms and suites, all with balcony
- ♦ 65 Grand Deluxe Rooms
- ♦ 82 Grand Premier Rooms*
- ♦ 37 Executive Club Rooms
- ♦ 32 Executive Suites
- ♦ 11 Grand Executive Suites
- ♦ 6 Two-bedroom Grand Executive Suites
- ♦ 34 Two-bedroom Premier Suites*
- ♦ 4 Three-bedroom Sindhorn Suites*
- ♦ 2 Sindhorn Presidential Suites*
- ♦ 1 Sindhorn Royal Suite*

* The Juice Butler delivers freshly squeezed juice to guestrooms 24/7

* Rooms/Residence Rooms/Suites with fully-equipped kitchenettes and washing machine with built-in dryer

GUEST ROOM FACILITIES

- ♦ Bangkok's largest rooms (from 66 sq m plus balcony)
- ♦ Luxuriously spacious bathrooms with freestanding bathtubs and separate shower room
- ♦ Infotainment systems with 55-inch Smart TV (65-inch for Suites)
- ♦ Private balcony
- ♦ Dining table
- ♦ Complimentary mini bar
- ♦ Complimentary Wi-Fi
- ♦ Wellness-inspired dining menu
- ♦ Coffee machine

RESTAURANTS & BARS

- ♦ Lobby Lounge
- ♦ Firefly Bar
- ♦ Flourish — All-day dining serving European, Arabic and Royal Thai cuisine
- ♦ Berthold Delikatessen
- ♦ Ki Izakaya
- ♦ Bistrot De La Mer

SERVICES & AMENITIES

- ♦ 24-hour laundry, dry-cleaning and ironing services
- ♦ 24-hour in-room dining
- ♦ 24-hour concierge services
- ♦ Shoeshine service
- ♦ PressReader digital newspaper
- ♦ Complimentary transportation to Chit Lom BTS and Lumpini MRT stations
- ♦ Juice Butler services+
- ♦ Well-being programmes
- ♦ Wellness concierge
- ♦ Executive Lounge with rooftop terrace and garden
- ♦ Limousine service
- ♦ Underground parking garage

MEETINGS & EVENTS

- ♦ Executive meeting rooms, outdoor lawn area and garden venues
- ♦ All meeting rooms with natural daylight
- ♦ Wellness-inspired menus
- ♦ Executive team building and health programmes

GENERAL INFORMATION

- ♦ Currency: Thai Baht (THB)
- ♦ Time zone: GMT +7 hours
- ♦ Climate: Tropical

PLACES OF INTEREST

- ♦ Lumpini Park
- ♦ Erawan Shrine
- ♦ Grand Palace
- ♦ Asiatique The Riverfront
- ♦ Central Chidlom
- ♦ Central Embassy
- ♦ Central World
- ♦ Siam Paragon
- ♦ Velaa Lifestyle Mall

DIRECTIONS

- ♦ Suvarnabhumi Airport, 33 km
- ♦ Don Muang Airport, 24 km
- ♦ BTS Chit Lom Station, 900 m
- ♦ BTS Ratchadamri Station, 750 m
- ♦ BTS Sala Daeng Station, 1.9 km

Meetings & Events



ROOM	FLOOR AREA in sq m	LENGTH in m	WIDTH in m	CEILING HEIGHT in m	RECEPTION 	BANQUET 	THEATRE 	CLASSROOM 	U-SHAPE 	BOARDROOM
Sindhorn 1	94	10.80	8.70	3.00	60	40	70	32	16	20
Sindhorn 2	70	10.80	6.50	3.00	50	40	70	24	16	20
Sindhorn 3	104	10.80	9.60	3.00	70	50	80	32	16	20
Sindhorn 4	89	11.80	7.50	3.00	60	40	70	24	16	20
Grand Sindhorn	268	10.80	24.80	3.00	150	130	220	88	-	-
Garden	436	32.00	18.00	-	180	150	-	-	-	-

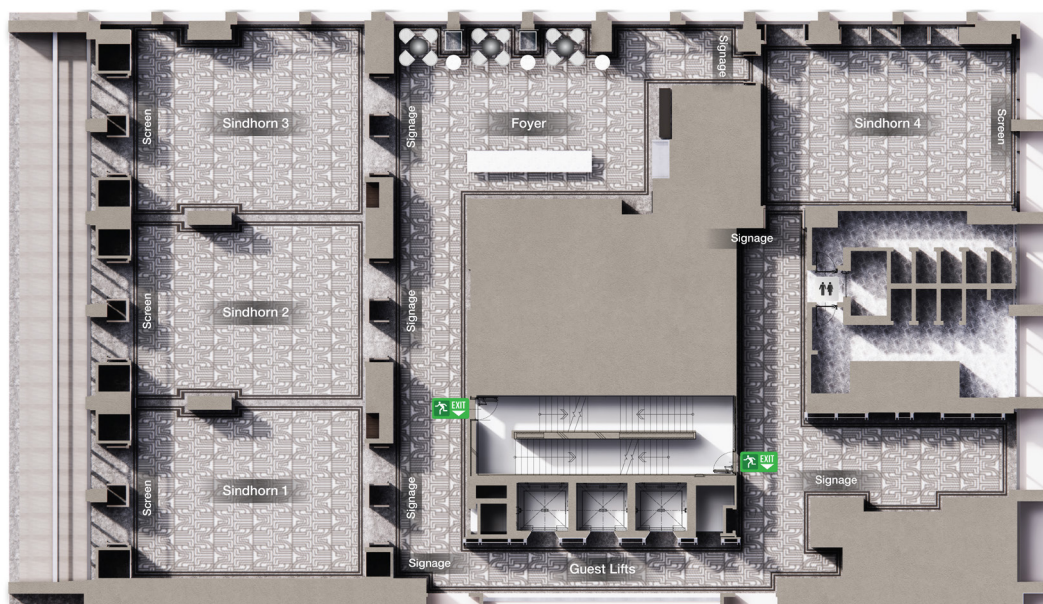

Life-enhancing Wellness Journeys



An oasis designed with space to breathe and a mission to prove Bangkok is more than a destination for spending sprees and indulgent temptations. Guests will be immersed in life-enhancing wellness journeys including personalised health, fitness and beauty programmes or retreats.

WELLNESS & ACTIVITIES

- 4,000 sq m integrated wellness inspired venues including outdoor areas for Tai Chi and Yoga
- Well-being programmes
- A total of 26 spa & wellness treatment spaces including a Hammam
- Fitness Club including HIIT Studio, Virtual Cycling, Movement, Yoga and Pilates Studios
- Wellness Programmes for nutrition, detox and executive reset
- Thermal Journeys
- Hydrotherapy experiences
- Detox circuit
- 25-metre outdoor saltwater pool
- Garden meditation walk and open spaces





HOTEL EXTERIOR



FLOURISH RESTAURANT



SINDHORN SUITE



GARDEN

Sindhorn Kempinski Hotel Bangkok remains committed to promoting best practices in sustainability from community engagement to environmental conservation. In recognition of our continued efforts, we have received EarthCheck Silver certification. Along with our LEED Silver certification, this confirms the hotel's compliance with the highest international standards for environmentally conscious operations and community support.



Contact Us

For an easy and efficient booking experience, book directly with Kempinski, via kempinski.com, through the Kempinski mobile app, or your preferred travel professional, and benefit from the best rates and service.



SINDHORN KEMPINSKI HOTEL BANGKOK
80 Soi Tonson, Lumpini, Pathumwan
Bangkok 10330
Thailand

T +66 (0) 2 095 9999
F +66 (0) 2 095 9998
reservation.sindhorn@kempinski.com
kempinski.com/sindhorn

GPS DMS: 13°44'12.2"N 100°32'38.2"E
GPS DD: 13.736728, 100.543942