

FACT SHEET

PROPERTY:	Siam Kempinski Hotel Bangkok	
ADDRESS:	Siam Kempinski Hotel Bangkok 991/9 Rama I Road, Pathumwan, Bangkok, 10330, Thailand.	
TELEPHONE:	+66 (0) 2 162 9000	
FACSIMILE:	+66 (0) 2 162 9009	
WEBSITE:	www.kempinski.com/bangkok	
OPENING DATE:	27 September 2010	
MANAGEMENT:	Kempinski Hotels S.A. 28 Boulevard du Pont-d'Arve 1205, Geneva, Switzerland	
INVESTORS/OWNERS:	Kempin Siam Co., Ltd.	
ARCHITECT, INTERIOR and LANDSCAPE DESIGNER:	Tandem Architects (2001) Co., Ltd. Hirsch Bedner Associated Pte. Ltd. Intaran Design Inc.	
SENIOR MANAGEMENT:	Senior Vice President Operations South-East Asia and General Manager Hotel Manager Regional Director of Sales and Marketing, South-EastAsia Director of Food & Beverage Director of Human Resources Director of Engineering Director of Finance Executive Chef	Samir R. Wildemann Jee Hoong Tan Sebastian de Vizcaya M.L Wannamart Thongtham Matthew W. Worth Nutchanart Samchiangphut James Norman
LOCATION:	Siam Kempinski Hotel Bangkok is located at the heart of Bangkok's premier shopping and entertainment district and within easy reach of the BTS SkyTrain at the Siam Interchange Station (in front of Siam Paragon Shopping Centre). The hotel provides direct access to Siam Paragon through the sky bridge located on Floor 2 of the Royal Wing.	

AIRPORT: Transfer times: 50 minutes from Suvarnabhumi International Airport Bangkok; 40 minutes from Don Mueang International Airport Bangkok (times are approximate and subject to local traffic conditions), and 10 minutes from Phaya Thai Airport Rail Link Station.

ACCOMMODATION: The hotel offers well-appointed guestrooms and suites. Most rooms feature breath-taking views of the lush garden and free-form swimming pool with 21 rooms offering direct access.

All rooms feature elegant and stylish contemporary décor with distinctive Thai elements and features reflected tastefully in the paintings, decorative items, silk curtains and panelling. Every room offers outstanding levels of comfort and luxury featuring state-of-the-art in-room entertainment systems, complimentary Wi-Fi, and daily replenishment of mini-bar to ensure that the guest experience matched the hotel's five star rating.

LEADING CATEGORY

Superior Room (59 rooms) – Located in the Residences Wing up to the 15th floor, with delightful garden views, have the atmosphere of a comfortable home. The rooms are spacious with an average size of 42 square metres. Selected rooms have a private balcony. There is a choice of a king bed or two twin beds in each room. A seating area, a generously-sized working desk, the large bathroom is equipped with a bathtub and a separate rain shower.

Deluxe Room (80 rooms) – Designed with the international business and leisure traveller in mind, the Deluxe Room offers guests supreme comfort and convenience. With the choice of a king or twin beds, the rooms have excellent views of the hotel's garden from either the windows or the optional balcony. Sized between 40 and 45 square metres, the Deluxe Rooms are located in the Royal Wing on Floors 2-8.

Premier Room (115 rooms) – Ranging from 45 to 60 square metres, the Premier Rooms are located on Floors 1-6 of the hotel's Garden Wing, providing guests with pleasant 'green' views of the hotel's majestic gardens from the panoramic windows or the optional balcony. Each room is enhanced visually with the clever yet subtle use of beige and other lighter colours as well as glass-fronted bathrooms. The effect is impressive, with each room feeling light, spacious and airy.

Executive Room (56 rooms) – Located on the prestigious upper floors of the Royal Wing from Floors 9-15, these rooms range in size from 40 to 48 square metres. Access to the hotel's exclusive Executive Lounge is available to all guests staying in an Executive Room. The extensive privileges and facilities include breakfast, afternoon tea and evening cocktails as well as complimentary private meeting rooms and secretarial services.

DIRECT POOL ACCESS CATEGORY

Unique to Siam Kempinski Hotel Bangkok is the Cabana Room and Duplex Cabana, offering direct pool access from a private terrace. Experience the ultimate city centre resort lifestyle whilst surrounded by beautiful lush gardens and free-form swimming pool.

Cabana Room (10 rooms) – Located on the Ground Floor of the hotel’s Garden Wing, the Cabana Rooms range from 40 to 48 square metres. All rooms offer direct access to the swimming pool from the private terrace. The understated elegance of the décor in the contemporary Thai design creates a seamless flow of comfort and beauty that unites the interior with the serene garden and outdoor free-form swimming pool.

Duplex Cabana (11 rooms) – Located in the hotel’s Garden Wing, these rooms range in size from 75 to 110 square metres. Each pool access suite features a living room and bedroom on a separate floor, allowing guests to relax in their own privacy whilst enjoying the pool. The room features a separate bathroom in the ground floor living room in addition to the en-suite bathroom on the upper floor.

SUITES

The hotel’s spacious suites provide luxurious accommodation for business and leisure guests. Each well-appointed suite offers spectacular and tranquil views of the lush garden and swimming pool. All guests booking suites enjoy exclusive access to the Executive Lounge.

Family Suite (26 rooms) – Family Suites are located in the Residences Wing up to Floors 15 and have a comfortable apartment-style ambience suitable for families with children. Connecting rooms are available for families that require extra space. The accommodation is exceptionally spacious at 91 square metres and most suites have a private balcony. There is a generously-sized kitchen that is equipped for preparing family meals, and a dining area with table and four chairs. The living room features soft, comfortable furnishings. The bedroom is equipped with a king bed, worktable, and walk-in closet. The large bathroom is fitted with double washbasins, bathtub and rain shower enclosure.

Executive Suite (16 rooms) – These elegant one-bedroom suites feature a separate bedroom and a spacious living room with work desk, offering guests a peaceful, yet business-like environment. The Executive Suites are located in the hotel’s Royal Wing and Garden Wing. All suites are designed in a contemporary Thai style with a beige colour scheme and Thai silk panels and curtains. The rooms range in size from 70 to 86 square metres.

Garden Suite (6 rooms) – These very spacious suites, measuring about 105 square metres, are located in the hotel’s Garden Wing. Each contemporary Thai-style, one-bedroom suite features a bathroom with a walk-in closet, a well-appointed living room with a working desk and a separate powder room.

Two-Bedroom Family Suite (12 rooms) – These suites have all the amenities of the standard Family Suites but provide, along with the king bedroom, a second bedroom equipped with twin beds. They are therefore very suitable for families. The suites have a very spacious area of 99 square metres, and being located at the corners of the Residences Wing they provide an extra degree of privacy. The lounge has all the seating comforts needed for a family, the generously sized kitchen can be used for preparing family meals, and there is a dining area that will seat four people with ease. There is also a work desk. The two bathrooms are fitted with rain showers and one of these bathrooms has a bathtub enclosure.

Deluxe Suite (6 rooms) – The elegant Deluxe Suites are located in the higher floors of the Royal Wing and range in size from 115 to 130 square metres. Each room features a spacious living room and dining area. A separate well-appointed bedroom features a custom-made king-sized bed, a walk-in closet and spacious bathroom with bespoke amenities.

Terrace Suite (1 room)– Located on Floor 5 of the Garden Wing, the Terrace Suite features an ample bedroom, sumptuous bathroom, private dining room and spacious living room with a separate guest powder room spread over 140 square metres. An outdoor terrace with 275 square metres is ideal for relaxing in style under the stars with a whirlpool, sun beds and dining table.

Presidential Suite (1 room) – Our one-of-a-kind Presidential Suite offers fine wood details, sumptuous Thai silk fabrics in a harmonised colour scheme of beige and gold and accents with understated elegance. The Presidential Suite includes an exquisitely appointed bedroom with a luxurious king-sized bed, a sumptuous living room with a balcony overlooking the garden and pools, a separate guest powder room, a private massage room, a study room, a living room and a kitchenette. The room offers a highly distinctive flat-screen TV from Bang & Olufsen with Video on Demand, Internet radio and an excellent media entertainment system, as well as iPod connectivity and LAN and wireless broadband Internet. Located on Floor 15 of the Royal Wing, the Presidential Suite occupies an area of 215 square metres.

Penthouse (1 room) – Set on Floor 17 of the Royal Wing, with magnificent views of the Bangkok skyline. The Penthouse represents stylish and privileged living. The entire area measures a spacious 260 square metres, with an elegantly decorated lounge in soft colours and with plenty of natural light from the full-length windows. There is also a kitchenette and a dining area. The accommodation features one king and one twin bedroom, and there are two bathrooms, each with a bathtub and a rain shower enclosure.

Royal Suite (1 room) – Recognised as one of the largest private suites in Bangkok, the Royal Suite encompasses the area of 300 square metres of indoor space with an additional 120 square metres for the outdoor terrace. Exclusively located on Floor 16 of the Royal Wing, this opulent suite features a luxurious master bedroom with a king-sized bed, a second bedroom with twin beds and a third smaller bedroom for personal staff or security – all with en-suite bathrooms. The interior design features a natural bright colour scheme and hand-selected Thai art pieces locally sourced by the team of Thai professors and students from the local University of Thailand. The Royal Suite also features a spacious living room with an elegant sofa set, separate dining room and private bar area with a marble counter bar, which is ideal for hosting an exclusive dinner or cocktail party. Additional amenities include the private gym, massage room, study room, and kitchenette, as well as a private terrace with a whirlpool and sun beds.

FEATURES & AMENITIES:

- 100% cotton oversized bath towels
- Cable television
- Coffee-and tea-making facilities
- Complimentary local daily newspapers
- DVD player on request
- Hair dryer
- Hypoallergenic pillows on request
- Individually controlled air-conditioning system

In-room safe
Iron and ironing board
Multi-line telephone(s) with voicemail
Laundry and dry-cleaning
Personal safe
Refrigerated private bar
Twice-daily housekeeping service
Wired and Wi-Fi broadband Internet
Complimentary mini-bar replenished daily

FOOD & BEVERAGE: Savour the authentic flavours of European and international cuisine or experience the art of modern Thai culinary delights in the charming settings at Siam Kempinski Hotel Bangkok's three restaurants and two bars.

Sra Bua by Kiin Kiin: This hotel's signature restaurant is conceptualised by renowned chef Henrik Yde Andersen, whose Kiin Kiin restaurant in Copenhagen, Denmark has been awarded one Michelin star since 2008 and is one of the renowned Thai restaurant with this prestigious honour. Diners are offered a set menu of modern Thai dishes with a unique, contemporary twist. Expert wine pairings complete the one-of-a-kind dining experience. An à la carte menu and business set lunch are also available daily.

Lunch: 12:00 – 15:00 hrs.
Dinner: 18:00 – 24:00 hrs.
Seating Capacity: 42 guests (dining area)
24 guests (lounge area)

Niche: This fun, casual and stylish all-day dining venue offers innovative international favourites prepared in 'Asian' or 'non-Asian' style. Extensive drink lists and relaxing outdoor atmosphere make Niche an ideal venue for a business or social rendezvous.

All-Day Dining: 12:00 – 24:00 hrs.
Seating Capacity: 78 guests (indoor)
50 guests (outdoor)

Brasserie Europa: This all-day dining restaurant offers international cuisine in an interactive dining atmosphere. The restaurant serves a scrumptious buffet breakfast, an international buffet for lunch and an à la carte menu featuring brasserie-style European dishes for dinner. The restaurant is famous for its legendary 'Bangkok's Longest Sunday Lunch' with free-flow champagne available until 17:00. Attentive service and stylish surroundings ensure that Brasserie Europa is an ideal venue for both business and leisurely dining.

A private dining room is available for a maximum of six guests for all occasions with the exception of Sunday lunch.

Breakfast: 6:30 – 10:30 hrs.
Lunch: 12:00 – 15:00 hrs.
Dinner: 18:30 – 22:30 hrs.
Sunday Longest Lunch: 12:30 – 17:00 hrs.
Seating Capacity: 108 guests (indoor)
72 guests (outdoor)

Rotunda: This resort-style pool bar nestles in the hotel's expansive landscape overlooking the hotel's free-form saltwater swimming pool. The bar offers all-day light meals, poolside snacks and refreshing beverages.

Bar Opening: 9:00 – 19:00 hrs.
Swimming Pool: 6:00 – 22:00 hrs.
(Lifeguard on duty from 8:00 - 19:00 hrs.)
Seating Capacity: 54 guests (lounge area)
16 guests (dining area)
59 sundeck loungers (outdoor)

Hanuman Bar: Situated in the hotel's majestic lobby, Hanuman Bar enjoys a reputation as a comfortable and sophisticated meeting place for morning coffee and pastries, the hotel's famous Afternoon Tea, and evening aperitifs and digestifs. The extensive drinks menu includes champagne from France's finest houses, outstanding new and old world wines, an impressive collection of spirits and creative cocktails prepared expertly and enthusiastically by the hotel's trained mixologists. Adjacent to Hanuman Bar is 1897 where smokers may enjoy their favourite cigars. This venue comprises an indoor lounge and a cosy private terrace.

Daily: 8:00 – 1:00 hrs.
Afternoon Tea: 14:00 – 17:00 hrs.
Seating Capacity: 45 guests

In-Room Dining: Available around the clock, the in-room dining menu features a wide choice of Thai, Western and Arabic cuisine with extensive drinks choices. A customised in-room dining menu for individuals or parties is available upon request.

EXECUTIVE LOUNGE:

Guests staying in Executive Rooms and all categories of suites enjoy complimentary access to the Executive Lounge. Located on Floor 17 of the Royal Wing, the Executive Lounge offers personalised check-in and check-out as well as basic secretarial services. It is also equipped with small meeting rooms available to guests (prior booking may be required). Complimentary non-alcoholic and selected alcoholic beverages, including beers and house wines, are available throughout the day. Guests can exclusively enjoy breakfast, all-day snacks, afternoon tea and evening cocktails with a variety of freshly made sandwiches and canapés.

Daily: 6:30 – 21:00 hrs.
Breakfast: 6:30 – 11:00 hrs.
Afternoon Tea: 14:00 – 16:00 hrs.
Evening Cocktails: 17:00 – 19:00 hrs.

Seating Capacity: Living Room Area 30 guests
Dining Area 34 guests

BANQUETING FACILITIES:

The Siam Kempinski Hotel Bangkok enjoys a prime location at the heart of the city's business and shopping district and is a popular choice with events/wedding planners and conference organisers.

All ten banqueting and meeting rooms, occupying a total space of 1,791sq m (19,500 sq ft) on Floor 2 of the Garden Wing, are elegantly decorated in contemporary Thai design with luxurious European touches. The meeting rooms are easy to access via the marble European-style staircase from the lobby or by using one of four elevators serving that floor. Behind each custom-made, Thai-style, golden-brass door is a venue that is magnificently decorated in shades of beige and light brown that complement the luxurious golden walls. Some rooms offer natural daylight with lush landscape views from the private balconies. All meeting rooms, including the pillar-less *Chadra Ballroom*, are well equipped with the latest conferencing technology, built-in audio, visual and sound equipment as well as high-speed internet access. Outdoor function space is also available in the garden area.

The hotel provides an extensive selection of menu options to suit every occasion from small business meetings to major international conferences, gala dinners and wedding banquets.

A 24-hour business centre located on the same floor offers secretarial, printing and photocopying services.

MEETING & BANQUET ROOMS:

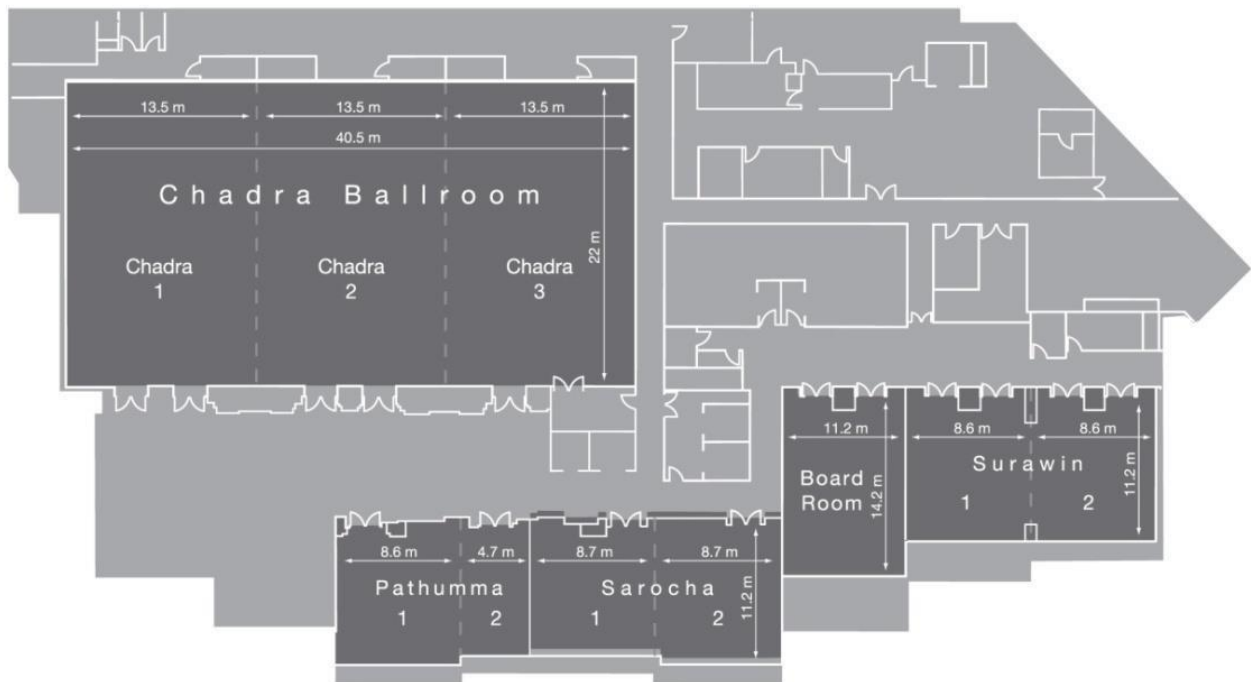

DIMENSION:

Venue	Area (sq.m.)	Theatre	Classroom	U-Shape	Boardroom	Banquet	Cocktail
Chadra Ballroom	900	950	600	120	-	660	1,200
Chadra 1	300	300	200	60	100	220	350
Chadra 2	300	300	200	60	100	220	350
Chadra 3	300	300	200	60	100	220	350
Pathumma	144	108	75	36	42	80	120
Pathumma 1	96	72	48	24	30	50	75
Pathumma 2	48	36	24	12	12	20	30
Sarocha	178	168	69	42	48	120	180
Sarocha 1	86	78	42	24	30	50	75
Sarocha 2	92	84	36	24	30	50	75
Surawin 1	98	84	48	21	30	50	75
Surawin 2	98	84	48	21	30	50	75
Boardroom	122	-	-	-	18	-	-

SPORTS FACILITIES:**FITNESS CENTRE**

Located on Floor 8 of the Garden Wing, the fitness centre is open 24 hours daily with supervision from well-trained staff from 6:30 to 23:00. The fitness centre is fully equipped with TECHNOGYM CARDIOVASCULAR equipment. It also features an aerobics room with a selection of classes, such as step aerobics, body stretching, muscle relaxation and Muay Thai, which are complimentary for hotel guests. A private class with a professional trainer is available at an additional charge.

KEMPINSKI THE SPA:

Embark on the ultimate spa journey at Kempinski The Spa, which is inspired by the European cycle of the seasons: spring, summer, autumn and winter. The signature treatments include the Seasonal Massage, which can be personalised according to the individual's seasonal element. Each treatment is designed to help restore the body's natural equilibrium by drawing on the elemental wisdom of nature. Other highlighted treatments include the Thai Massage, the Thai Herbal Compress Massage, facial treatments and body scrubs. The therapists, each with over a decade of professional experience, are committed to delivering the best pampering experience for each individual guest with gracious Thai hospitality.

Located on Floor 7 of the Garden Wing, Kempinski The Spa features eight beautifully appointed treatment rooms and suites. The spa is open daily from 10:00 to 22:00. Foot massages as well as manicures, pedicures and waxing services are also available.

BUSINESS CENTRE:

The business centre is located on Floor 2 of the Garden Wing and is opened daily from 9:00 to 19:00. This comprehensive service centre can cater to all your business and secretarial needs and offers mobile telephone rental service, local pre-paid SIM cards, photocopying, printing and scanning, video conferencing, internet computer stations and meeting rooms.

KIDS CLUB:

The Kempinski Kids Club welcomes in-house children aged from 3 to 12. To keep your young ones entertained, it provides an educational and fun environment supervised by qualified staff. Kids Club is located on the Ground floor of the Royal Wing and is open daily from 9:00 to 18:00.

CURRENCY: Thai Baht (THB)

CLIMATE: Thailand has three distinct seasons of cool, hot and rainy. The cool season lasts from November to February with warm temperatures during the day and cool conditions in the morning and evening. The average December temperature in Bangkok is 26°C (78°F). The hot season lasts from March to May with temperatures reaching 39°C (102°F). June to October is the rainy season with almost daily rain showers and high humidity with temperatures around 30°C (86°F).

VOLTAGE: The hotel operates on 110 and 220 volt power.

IMMIGRATION: Visa requirements are determined by nationality. Visitors are requested to consult with the Thai consulate in their countries.

#####